

◆Precautions of Installation

1. This product is delivered to consumers after strict quality inspection,please don't disassemble it by yourself.
2. Before installing the shower set ,please must be flush waterway thoroughly to prevent impurities in the waterway from blocking the mixer and affecting the normal use of the product.
3. Please follow installation drawing pictures to install the faucet and make sure the installation is correct.Don't force installation to avoid damage the mixer and accessories.
4. The connection between the faucet and the cold and hot water pipes must be correct.Facing the faucet,hot water on the left and cold water on the right.
5. Once the mixer is installed,please turn on the water and check each connection for leaks.
6. The range of the faucet suitable temperature:suitable hot water temperature:55-85°C,cold water temperture:4-29°C.

The suggestion of hot water temperature is 55°C-65°C.

The range of faucet water pressure:0.05-0.75 Mpa.

Recommendation: 0.1-0.5 Mpa

◆Product care and maintenance to keep the faucet surface clean and bright,please follow these care tips:

1. In genral,just clean with clear water and use a soft cotton cloth to wipe dry.
2. If water can't be rinse off,please use soft liquid cleanser to clean it.After cleaning,please dry the faucet with clean water and a soft cotton cloth.
3. Don't use any abrasive cleaning utensils to clean the faucet,such as metal brush,scouring pad,etc.
4. Don't use any acid, alkaline and abrasive cleaners to clean the faucet,such as stain removers,etc.
6. Please turn off the inlet valve in your home when nobody is at home to prevent damage to the product due to changes in pipe pressure.

Especially when the temperature near the mixer is lower than 0 °C, the main water valve switch should be turned off, and the remaining water inside the water pipe and the faucet should be drained, so as not to cause the internal water to freeze and crack the mixer and water pipe.

If you have any questions during installation or use, please contact the local dealer.

◆Instructions for Use

1. Turn the adjust temperature handle to control the water outlet temperature.Turn the handle clockwise to low temperature and turn the handle counterclockwise to high temperature.When the temperture rised by 38°C,you need to press the anti-scald button , then you can continue to increase the temperature.
2. Turn the shower head switch handle counterclockwise and the shower head outlet water.The greater the rotation angle then the greater the flow. Turn the hand shower switch handle clockwise and the hand shower outlet water.The greater the rotation angle then the greater the flow.
3. The rise and fall of press slide set button adjustable sliding sleeve position.

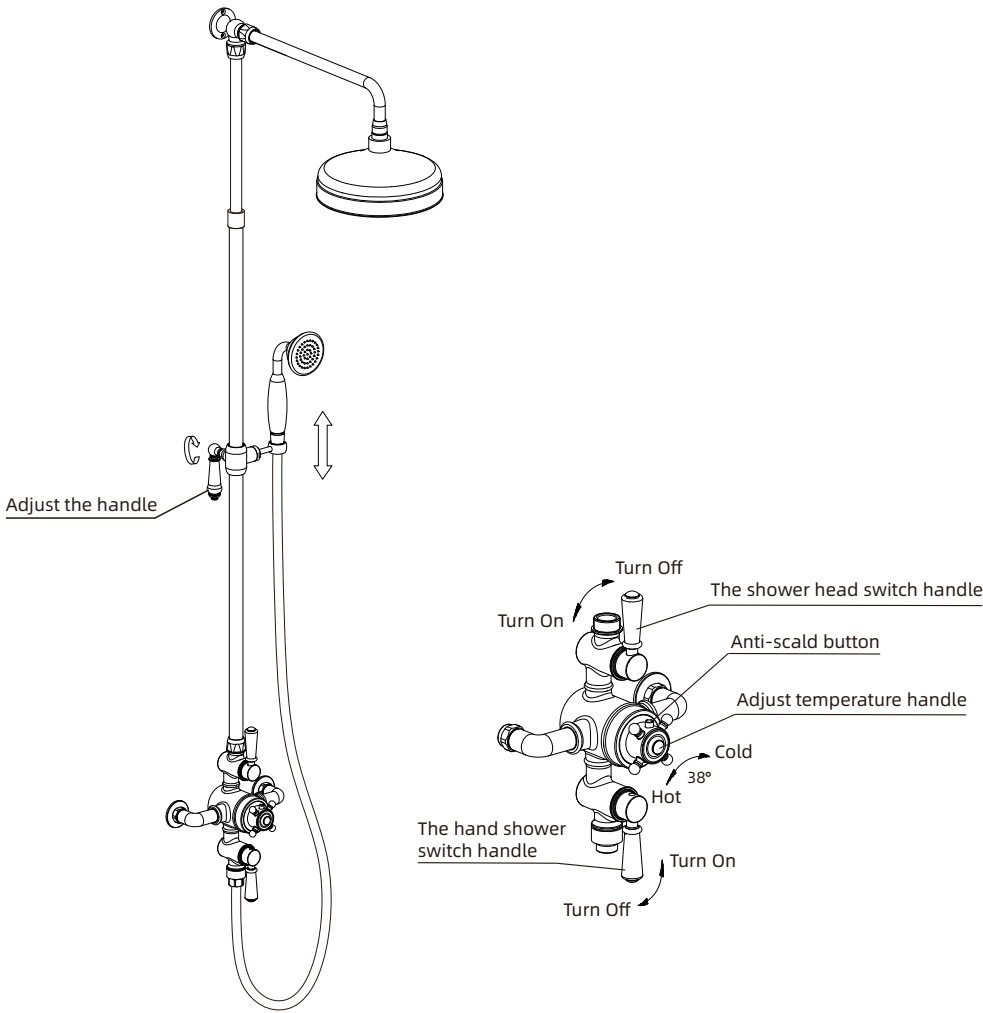

Instruction of Thermostatic Bath-Shower

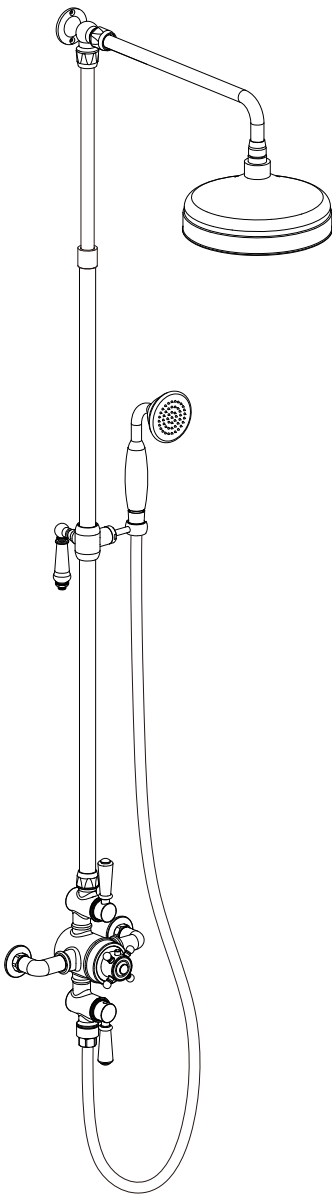

Please read this manual carefully before using the product, and please keep this manual properly.

The Picture of Product Installation

Attention:Please read the entire contents of this installation manual carefully about before using and installing.

After opening the package,please follow the accessiores listed in the list or pictures and check if they are complete.If have the lose one,please contact with local dealer or our company in time.

Install the required tools:Adjustable Spanner,Allen Wrench,Phillips Screwdriver,Impact Drill,Hammer,Safety Goggles,PTFE Tape,Spirit Level

The List of Standard Accessiores

Number	Name	Quantity
1	Mixer	1
2	Shower straight pipe set	1
3	Components of fixed holder	1
4	Shower horizontal pipe	1
5	Shower head	1
6	Hand shower	1
7	Shower hose	1
8	Small face plate	2
9	O-ring	2
10	Eccentric	2
11	Instruction book	1

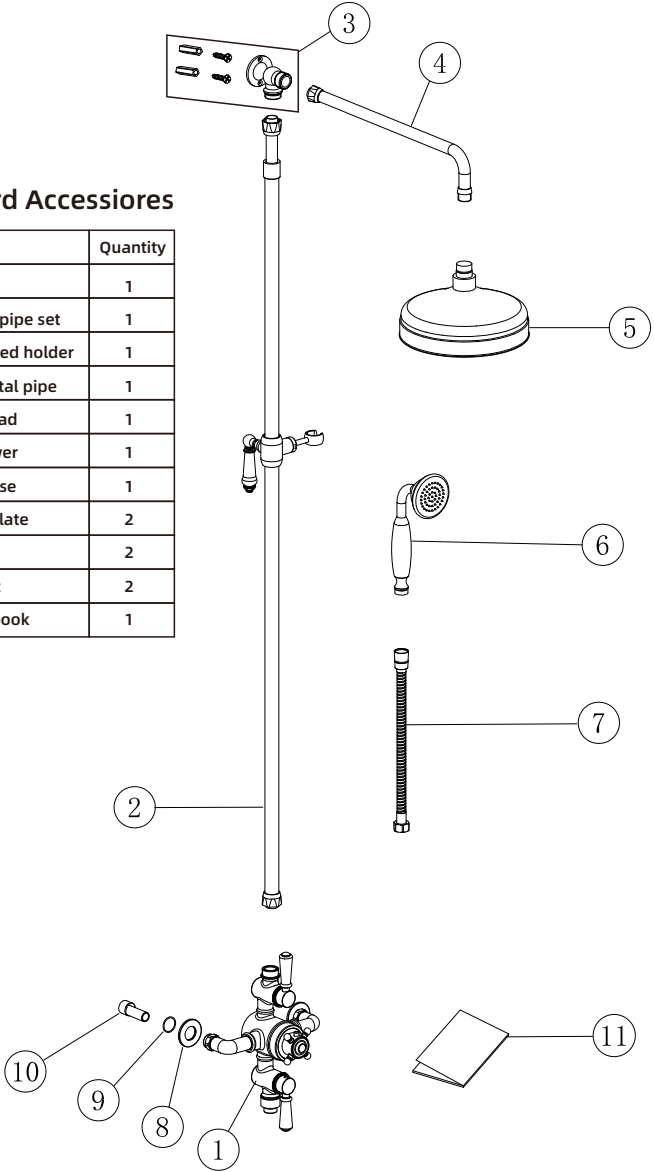

Steps of Instrallation

- The joint should be as flush as possible with the wall or within 10mm below the wall.

1000-1200

150±10

Hot

Cold

1. First ensure to let two outlets is on the same level before instrallation and the deviation of the distance between two water outlets is within the allowable range.Please use the left-hot right-cold connection for the cold and hot water.
2. After wrapping the eccentric with PTFE tape,please connect with the pre-embedded water outlet pipe connector.Attach the mixer to the eccentric and mark the location of the base on the wall.

3. Drill holes in the wall and drive the expanded rubber into the wall,and fix the base to the wall with self-tapping screws.

4. Install the small plate and eccentric to the mixer, and the mixer and the base are fixed with hexagon socket screws.

5. Connect the components of shower pipe to the water outlet connector on the mixer,stretch the shower pipe to a suitable height and mark the location of the fixing base.

6. Remove the shower pipe assembly from the mixer,drill holes and install the expanded rubber at the location marked on the fixing base.

7. Connect the shower pipe to the mixer and the fixing base,and fix the fixing base to the wall with self-tapping screws and connect to horizontal pipe.

8. Finally,connect the shower hose,hand shower and shower head.The installation is complete.
-